

Hammond Elementary School

11520 - 203rd Street, Maple Ridge, B.C. V2X 4T6
Tel: (604) 460-1136 Fax: (604) 460-1137
Website: (<http://schools.sd42.ca/hammond/>)



Principal: Mr. Wes Reamsbottom
Vice Principal: Ms. Megan Olynyk

Dear Hammond Families,

As the first week of school approaches, I wanted to send you a schedule complete with dates, times and maps to help with drop off and pick up during the first week at school.

First Week Schedule:

September 8th & 9th – Teacher preparation for re-open – *no students in session.*

September 10th and 11th – *students return for two hours each day.*

- Group A 8:30-10:30 (grades 1-3)
- Group B 12:20-2:20 (grades 4-7 – including Div. 14 grade 3/4/5 Montessori)

K/1 First week

- Grade 1s attend in Group A with K/1 teachers 8:30-10:30 as above.
- K intake meetings will be scheduled after 10:30 on Thursday the 10th and Friday the 11th.

Drop-off/Pick-up:

In support of minimizing physical contact/physical distancing between cohorts, students will be met at their designated line-up location at 8:30 am and led in a controlled manner into classrooms. At 2:20 pm, students will be led by staff out of the building to the location noted on the map for dismissal to parents. If your child will be picked up by someone other than a parent, please be sure to provide the school office with appropriate details. All adults must socially distance when they are on school property, especially if you are waiting with your children. Parents are asked to not linger outside after their child has been admitted to the building as this is not a time for meeting or socializing.

Consistent with recommendations from public health, **entry into the school building will be limited to students and staff.** Should you require assistance, please call the office (604) 460-1136 between the hours of 8:00 am and 3:30 pm to make an appointment if you need to enter.

Required Daily Health Screening:

You must assess your child(ren) every morning before sending them to school. All students who have any of the following symptoms must stay at home and parents should follow up with their health care provider or call 811:

- common cold symptoms
- influenza (flu) symptoms
- COVID-like symptoms
- Symptoms of any other infectious respiratory disease

If any family member or close contact of your child(ren) is showing COVID-like symptoms or has been confirmed to have contracted COVID-19, your child must stay home and you should contact your health care provider or call 811.

If your child becomes ill while at school, we will follow the advice set out in [Public Health Guidance for K-12 School Settings](#) and contact you to come to the school right away to pick up your child.

Divisions with room number and Teacher names for morning lining up and dismissal:

Div. 1 (2018)	Ms. Suhopoljac/Ms. Hague
Div. 2 (2019)	Ms. Odette
Div. 3 (2020)	Ms. Quarto
Div. 4 (2009)	Mr. Sales
Div. 5 (2006)	Ms. Vanlerberg/Severinski
Div. 6 (2007)	Ms. Lummis
Div. 7 (1013)	Ms. Lindgren
Div. 8 (1030)	Ms. Edgett
Div. 9 (2005)	Ms. Farley / Ms. McKay
Div. 10 (1015)	Ms. Andrews
Div. 11 (1017)	Ms. Clearihue/Ms. Sigvaldason
Div. 12 (2008)	Ms. Jones
Div. 13 (2011)	Mr. Dowler
Div. 14 (2012)	Ms. Voytechek
Div. 15 (1012)	Ms. Patrick
Div. 16 (1027)	Ms. Williams
Div. 17 (1031)	Ms. Warne
Div. 18 (1014)	Ms. Meedin
Div. 19 (1019)	Ms. Situ

HAMMOND ELEMENTARY SCHOOL
 11520 203rd Street, Maple Ridge, V2X 4T6

Original Construction 2000
 3,535 m²



Grades 4-7 Line Up Zones
 (Including Div. 14 (3-4-5 Mont.)

- Blue**—Div. 1, 2, 3
- Orange**—Div. 4, 5
- Purple**—Div. 6
- Red**—Div. 12, 13, 14

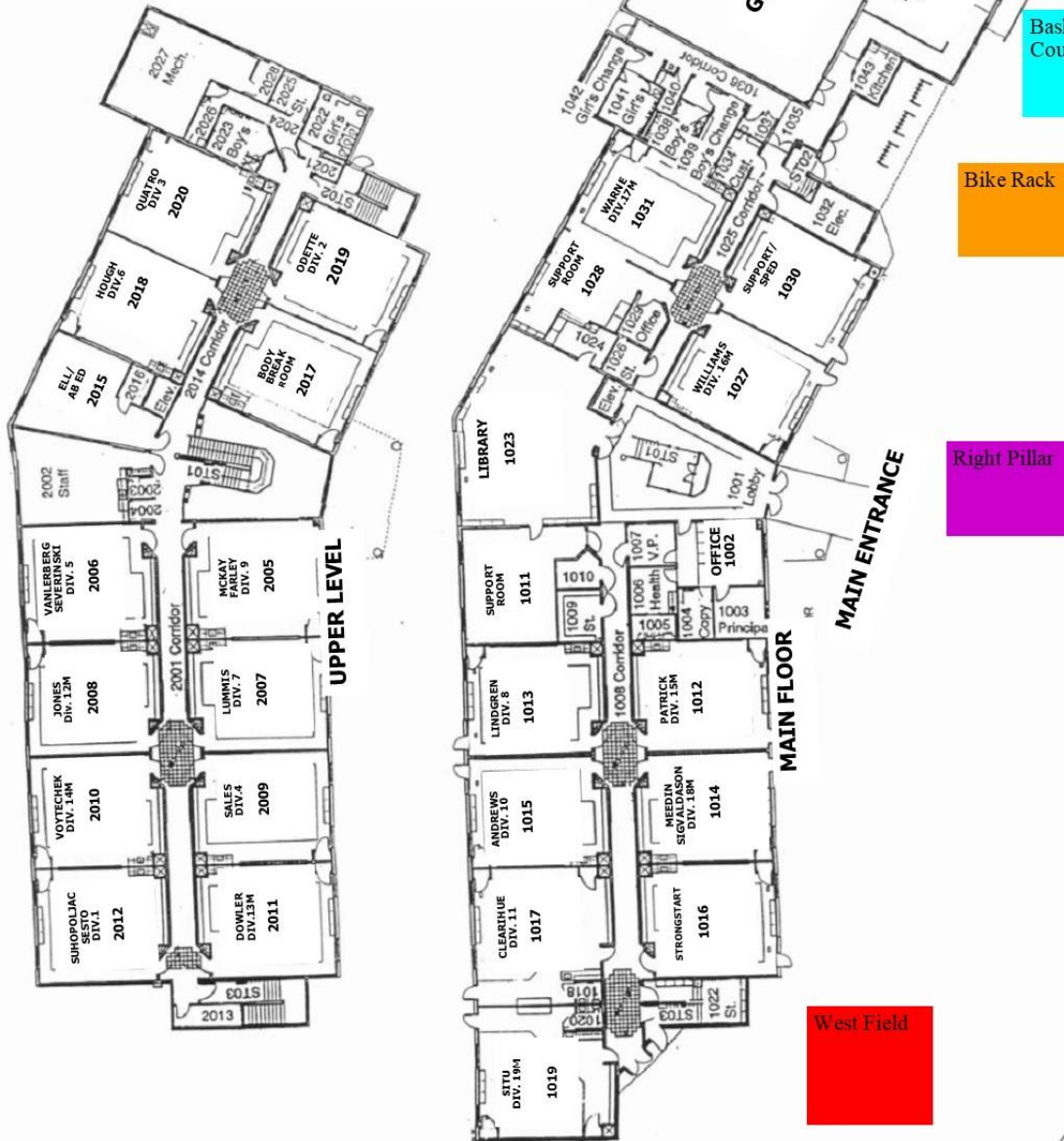

Basketball Court

Bike Rack

Right Pillar

West Field

HAMMOND ELEMENTARY SCHOOL
 11520 203rd Street, Maple Ridge, V2X 4T6

Original Construction 2000
 3,535 m²



Grades K-3 Drop off / Pick Up Zones

Please send to Div. exterior doors except where marked below:

Green—Div. 9 (Farley / McKay)
Lavender—Div 20 (Warne)

